

SMD DR FILTER

TYPE
M

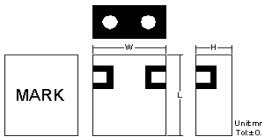

For CT1, CT2, 900MHz, 1.8GHz, 2.4GHz, 5.8GHz Cordless Phone, wireless earphone, wireless microphone etc.

| Temstron No. | Center Frequency (MHz) | Band Width (MHz) min | Insertion Loss (dB) max. | Ripple in BW (dB) max. | V.S.W.R. Max. | Attenuation (dB) min. (MHz) | Dimension W x H x L (max) (mm) |
|---------------|------------------------|----------------------|--------------------------|------------------------|---------------|----------------------------------|--------------------------------|
| TSDRM-457 | 457.0 | fo ± 15.0 | 2.5 | 1.0 | 2.0 | 10 at fo + 50 20 at fo - 50 | 7.4 x 3.6 |
| TSDRM-864 | 864.0 | fo ± 5.0 | 3.5 | 1.0 | 1.5 | 15 at fo + 24 17 at fo - 24 | 7.4 x 3.6 |
| TSDRM-915 | 915.0 | fo ± 12.5 | 2.0 | 1.0 | 2.0 | 20 at fo + 100 35 at fo - 100 | 7.4 x 3.6 |
| TSDRM-1575P42 | 1575.42 | fo ± 10.0 | 3.5 | 1.0 | 2.0 | 30 at fo ± 100 | 7.4 x 3.6 |
| TSDRM-650 | 650.0 | fo ± 15.0 | 2.5 | 1.0 | 1.5 | 19 at fo ± 64 | 6.0 x 3.0 |
| TSDRM-776 | 776.0 | fo ± 6.5 | 3.0 | 1.0 | 2.0 | 18 at fo + 64 40 at fo - 64 | 6.0 x 3.0 |
| TSDRM-850 | 850.0 | fo ± 4.0 | 5.0 | 1.0 | 1.5 | 28 at fo + 50 35 at fo - 100 | 6.0 x 3.0 |
| TSDRM-916 | 916.0 | fo ± 15.0 | 2.5 | 1.0 | 1.5 | 20 at fo ± 70 | 6.0 x 3.0 |
| TSDRM-1575P42 | 1575.42 | fo ± 5.0 | 3.5 | 1.0 | 2.0 | 35 at fo - 100 25 at fo + 100 | 5.8 x 2.8 |
| TSDRM-2326 | 2326.0 | fo ± 7.0 | 3.0 | 1.0 | 2.0 | 30 at fo - 100 20 at fo + 100 | 6.0 x 3.0 |
| TSDRM-1575P42 | 1575.42 | fo ± 15.0 | 2.5 | 1.0 | 2.0 | 25 at fo - 100 16 at fo + 100 | 4.5 x 2.0 |
| TSDRM-1890 | 1890.0 | fo ± 40.0 | 2.0 | 1.0 | 2.0 | 15 at fo + 250 35 at fo - 250 | 4.5 x 2.0 |
| TSDRM-2450 | 2450.0 | fo ± 50.0 | 2.0 | 1.0 | 2.0 | 12 at fo + 250 15 at fo - 250 | 4.5 x 2.0 |
| TSDRM-3650 | 3650.0 | fo ± 75.0 | 2.0 | 1.0 | 2.0 | 15 at fo + 750 25 at fo - 750 | 4.5 x 2.0 |
| TSDRM-5800 | 5800.0 | fo ± 100.0 | 2.0 | 1.0 | 2.0 | 5 at fo + 400 15 at fo - 400 | 4.5 x 2.0 |

Microwave telecommunication, Base station, Repeater, Radar, Electronic counterwork, Aviation and spaceflight, Navigation, etc.

| Temstron No. | Center Frequency (MHz) | Band Width (MHz) min | Insertion Loss (dB) max. | Ripple in BW (dB) max. | V.S.W.R. Max. | Attenuation (dB) min. (MHz) | Dimension W x H x L (max) (mm) |
|--------------|------------------------|----------------------|--------------------------|------------------------|---------------|-----------------------------|--------------------------------|
| TSDRM-1472 | 1472.0 | fo ± 20 | 3.0 | 0.8 | 2.0 | 20 at fo ± 72 | 5.7 x 2.0 |
| TSDRM-2140 | 2140.0 | fo ± 30 | 3.0 | 0.5 | 1.5 | 25 at fo 150 | 5.7 x 2.0 |
| TSDRM-735 | 735.0 | fo ± 15 | 3.0 | 1.0 | 2.0 | 38 at fo ± 110 | 8.5 x 3.0 |
| TSDRM-851 | 851.0 | fo ± 18 | 3.0 | 1.0 | 2.0 | 38 at fo ± 110 | 8.5 x 3.0 |
| TSDRM-945 | 945.0 | fo ± 15 | 2.5 | 0.8 | 2.0 | 32 at fo ± 100 | 8.5 x 3.0 |
| TSDRM-1694 | 1694.0 | fo ± 20 | 3.5 | 1.0 | 2.0 | 10 at fo ± 40 | 8.5 x 3.0 |
| TSDRM-950 | 950.0 | fo ± 7.5 | 4.0 | 1.0 | 1.8 | 30 at fo ± 50 | 11.8 x 3.8 |
| TSDRM-1500 | 1500.0 | fo ± 25 | 2.5 | 1.0 | 2.0 | 30 at fo ± 100 | 11.8 x 3.8 |
| TSDRM-2017P5 | 2017.5 | fo ± 7.5 | 3.0 | 0.5 | 1.5 | 35 at fo ± 88.5 | 11.8 x 3.8 |
| TSDRM-3200 | 3200.0 | fo ± 10.0 | 4.5 | 1.0 | 1.8 | 35 at fo ± 70 | 11.8 x 3.8 |
| TSDRM-4700 | 4700.0 | fo ± 10.0 | 6.0 | 1.0 | 1.5 | 40 at fo ± 100 | 11.8 x 3.8 |
| TSDRM-400 | 400.0 | fo ± 2 | 3.0 | 1.0 | 1.5 | 35 at fo ± 50 | 12.0 x 5.0 |
| TSDRM-1472 | 1472.0 | fo ± 20 | 1.0 | 0.5 | 2.0 | 25 at fo ± 100 | 17.0 x 5.8 |
| TSDRM-2200 | 2200.0 | fo ± 60 | 2.0 | 1.0 | 2.0 | 60 at fo - 450 | 17.0 x 5.8 |
| TSDRM-796 | 796.0 | fo ± 1.5 | 4.0 | 1.0 | 1.5 | 20 at fo ± 20 | 15.2 x 3.8 |
| TSDRM-945 | 945.0 | fo ± 15 | 3.0 | 1.0 | 2.0 | 30 at fo ± 50 | 15.2 x 3.8 |
| TSDRM-1150 | 1150.0 | fo ± 18 | 3.0 | 1.0 | 2.0 | 20 at fo ± 36 | 15.2 x 3.8 |
| TSDRM-2980 | 2980.0 | fo ± 25 | 3.0 | 1.0 | 2.0 | 50 at fo ± 200 | 15.2 x 3.8 |
| TSDRM-3880 | 3880.0 | fo ± 20 | 4.0 | 1.0 | 2.0 | 25 at fo ± 100 | 15.2 x 3.8 |
| TSDRM-500 | 500.0 | fo ± 10 | 4.0 | 0.8 | 1.8 | 45 at fo ± 70 | 20.0 x 5.0 |

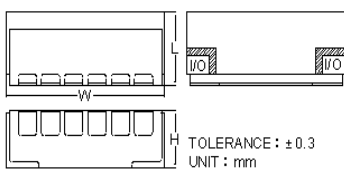

TYPE
M



| Temstron No. | Center Frequency (MHz) | Band Width (MHz) min | Insertion Loss (dB) max. | Ripple in BW (dB) max. | V.S.W.R. Max. | Attenuation (dB) min. (MHz) | Dimension W x H x L (max) (mm) |
|---------------|------------------------|----------------------|--------------------------|------------------------|---------------|----------------------------------|--------------------------------|
| TSDRM-1600 | 1600.0 | fo ± 20 | 1.5 | 0.5 | 1.6 | 40 at fo ± 150 | 9.2 x 4.0 x 9.9 |
| TSDRM-2500 | 2500.0 | fo ± 50 | 0.8 | 0.5 | 1.5 | 50 at fo - 800 | 9.2 x 4.0 x 8.5 |
| TSDRM-1080 | 1080.0 | fo ± 30 | 3.5 | 1.5 | 1.6 | 15 at fo ± 50 | 10.8 x 4.0 x 9.1 |
| TSDRM-2593 | 2593.0 | fo ± 93 | 1.8 | 1.0 | 2.0 | 50 at fo - 400 38 at fo + 400 | 15.0 x 4.1 x 7.0 |
| TSDRM-3500 | 3500.0 | fo ± 110 | 1.5 | 0.5 | 1.6 | 40 at fo ± 150 | 10.8 x 4.0 x 6.2 |
| TSDRM-836P5 | 836.5 | o ± 12.5 | 3.5 | 1.0 | 1.5 | 25 at fo ± 32.5 | 13.5 x 4.0 x 11.5 |
| TSDRM-1200 | 1200.0 | fo ± 3 | 5.0 | 1.0 | 2.0 | 20 at fo ± 20 | 13.5 x 4.0 x 11.5 |
| TSDRM-2350 | 2350.0 | fo ± 6 | 4.0 | 1.0 | 2.0 | 20 at fo ± 20 | 12.5 x 5.5 x 18.0 |
| TSDRM-450 | 450.0 | fo ± 7.5 | 2.5 | 1.0 | 1.5 | 50 at fo ± 56 | 12.5 x 5.5 x 18.0 |
| TSDRM-500 | 500.0 | fo ± 2.5 | 3.5 | 0.5 | 2.0 | 23 at fo ± 50 | 20.0 x 5.5 x 17.0 |
| TSDRM-600 | 600.0 | fo ± 30 | 3.0 | 0.5 | 1.5 | 20 at fo ± 25 | 21.2 x 5.5 x 14.0 |
| TSDRM-1200 | 1200.0 | fo ± 1.5 | 3.0 | 1.0 | 1.8 | 18 at fo ± 80 | 21.2 x 5.5 x 11.0 |
| TSDRM-2400 | 2400.0 | fo ± 40 | 3.0 | 1.0 | 1.5 | 60 at fo ± 250 | 21.2 x 5.5 x 11.5 |
| TSDRM-1000 | 1000.0 | fo ± 25 | 3.0 | 1.0 | 1.5 | 40 at fo - 40 | 21.5 x 5.5 x 9.5 |
| TSDRM-3300 | 3300.0 | fo ± 3 | 4.5 | 1.0 | 1.6 | 20 at fo ± 50 | 21.5 x 5.5 x 9.0 |
| TSDRM-1575P42 | 1575.42 | fo ± 25 | 1.0 | 0.3 | 1.5 | 40 at fo ± 100 | 17.0 x 6.0 x 8.5 |
| TSDRM-1400 | 1400.0 | fo ± 2 | 3.0 | 0.5 | 1.5 | 25 at fo ± 96 | 19.5 x 6.5 x 8.0 |
| TSDRM-580 | 580.0 | fo ± 27.5 | 3.5 | 1.0 | 2.0 | 50 at fo ± 24 | 28.0 x 6.5 x 15.5 |
| TSDRM-1250 | 1250.0 | fo ± 4 | 3.0 | 0.5 | 1.5 | 40 at fo ± 30 | 28.0 x 6.5 x 12.0 |
| TSDRM-2500 | 2500.0 | fo ± 57.5 | 2.5 | 0.5 | 2.0 | 50 at fo ± 160 | 28.0 x 6.5 x 7.5 |
| TSDRM-1100 | 1100.0 | fo ± 4 | 5.5 | 1.0 | 1.5 | 35 at fo ± 10 | 33.2 x 6.5 x 14.0 |
| TSDRM-1180 | 1180.0 | fo ± 100 | 3.0 | 1.0 | 2.0 | 40 at fo ± 200 | 24.5 x 8.0 x 11.5 |
| TSDRM-2000 | 2000.0 | fo ± 50 | 4.0 | 1.0 | 1.5 | 35 at fo ± 100 | 24.5 x 8.0 x 10.0 |
| TSDRM-600 | 600.0 | fo ± 5 | 6.0 | 1.0 | 1.8 | 20 at fo ± 11 | 33.2 x 8.1 x 15.0 |
| TSDRM-1220 | 1220.0 | fo ± 60 | 1.5 | 1.0 | 2.0 | 45 at fo + 100 80 at fo - 100 | 33.2 x 8.1 x 12.5 |
| TSDRM-2200 | 2200.0 | fo ± 25 | 3.5 | 1.0 | 1.5 | 65 at fo ± 70 | 33.2 x 8.1 x 9.5 |
| TSDRM-3500 | 3500.0 | fo ± 75 | 4.0 | 1.0 | 2.0 | 45 at fo ± 175 | 33.2 x 8.1 x 8.0 |
| TSDRM-950 | 950.0 | fo ± 12.5 | 4.0 | 1.5 | 2.0 | 50 at fo ± 30 | 41.5 x 8.0 x 11.0 |

| Temstron No. | Center Frequency (MHz) | Band Width (MHz) min | Insertion Loss (dB) max. | Ripple in BW (dB) max. | V.S.W.R. Max. | Attenuation (dB) min. (MHz) | Dimension W x H x L (max) (mm) |
|--------------|------------------------|----------------------|--------------------------|------------------------|---------------|-----------------------------|--------------------------------|
| TSDRM-729 | 729.0 | fo ± 6 | 3.0 | 1.0 | 1.5 | 30 at fo ± 100 | 9.5 x 5.0 x 12.0 |
| TSDRM-860 | 860.0 | fo ± 10 | 3.0 | 1.0 | 1.5 | 12 at fo ± 45 | 9.5 x 5.0 x 11.0 |
| TSDRM-1656P5 | 1656.5 | fo ± 11.5 | 2.0 | 0.5 | 1.5 | 40 at fo ± 130 | 12.5 x 5.0 x 10.0 |
| TSDRM-900 | 900.0 | fo ± 15 | 3.0 | 0.8 | 1.5 | 40 at fo ± 55 | 13.5 x 5.0 x 13.5 |
| TSDRM-945 | 945.0 | fo ± 15 | 3.0 | 0.8 | 1.5 | 40 at fo ± 55 | 13.5 x 5.0 x 13.5 |
| TSDRM-1720 | 1720.0 | fo ± 10 | 3.0 | 1.0 | 1.5 | 18 at fo ± 40 | 13.5 x 5.0 x 13.5 |
| TSDRM-1815 | 1815.0 | fo ± 10 | 3.0 | 1.0 | 1.5 | 40 at fo ± 55 | 13.5 x 5.0 x 13.5 |
| TSDRM-912 | 912.0 | fo ± 3 | 3.5 | 1.0 | 1.5 | 50 at fo ± 100 | 14.0 x 4.5 x 11.5 |
| TSDRM-957 | 957.0 | fo ± 3 | 2.5 | 1.0 | 1.5 | 50 at fo ± 100 | 14.0 x 4.5 x 11.5 |
| TSDRM-1950 | 1950.0 | fo ± 30 | 2.5 | 1.0 | 1.5 | 55 at fo ± 160 | 14.0 x 4.5 x 8.0 |
| TSDRM-2140 | 2140.0 | fo ± 30 | 2.5 | 1.0 | 1.5 | 55 at fo ± 160 | 14.0 x 4.5 x 8.0 |
| TSDRM-2600 | 2600.0 | fo ± 100 | 3.0 | 1.0 | 2.0 | 20 at fo ± 170 | 14.0 x 4.5 x 8.0 |
| TSDRM-2500 | 2500.0 | fo ± 20 | 3.0 | 1.0 | 1.5 | 15 at fo ± 50 | 22.5 x 6.5 x 11.0 |
| TSDRM-2633 | 2633.0 | fo ± 33 | 2.0 | 1.0 | 1.5 | 35 at fo - 90 | 19.2 x 7.0 x 13.0 |
| TSDRM-1616 | 1616.0 | fo ± 5 | 10.0 | 1.0 | 1.5 | 50 at fo ± 30 | 25.0 x 6.5 x 11.0 |
| TSDRM-2300 | 2300.0 | fo ± 50 | 2.5 | 1.0 | 1.5 | 30 at fo ± 100 | 27.0 x 9.0 x 12.0 |
| TSDRM-3250 | 3250.0 | fo ± 12.5 | 3.0 | 1.5 | 1.5 | 70 at fo - 100 | 27.0 x 9.0 x 12.0 |
| TSDRM-1260 | 1260.0 | fo ± 7.5 | 6.0 | 0.5 | 1.5 | 60 at fo ± 30 | 33.4 x 9.0 x 16.0 |
| TSDRM-836P5 | 836.5 | fo ± 12.5 | 3.0 | 1.0 | 1.5 | 45 at fo ± 32.5 | 33.4 x 9.0 x 16.0 |
| TSDRM-881P5 | 881.5 | fo ± 12.5 | 3.0 | 1.0 | 1.5 | 45 at fo ± 32.5 | 33.4 x 9.0 x 16.0 |
| TSDRM-1880 | 1880.0 | fo ± 30 | 2.5 | 0.6 | 1.5 | 30 at fo ± 70 | 33.4 x 9.0 x 11.5 |
| TSDRM-1960 | 1960.0 | fo ± 30 | 2.5 | 0.6 | 1.5 | 30 at fo ± 70 | 33.4 x 9.0 x 11.5 |
| TSDRM-902P5 | 902.5 | fo ± 12.5 | 3.8 | 1.5 | 1.5 | 60 at fo ± 859 | 42.0 x 9.5 x 17.0 |
| TSDRM-947P5 | 947.5 | fo ± 12.5 | 3.8 | 1.5 | 1.5 | 60 at fo ± 859 | 42.0 x 9.5 x 17.0 |
| TSDRM-1747P5 | 1747.5 | fo ± 37.5 | 3.3 | 1.5 | 1.5 | 45 at fo ± 1842.5 | 43.5 x 9.5 x 13.0 |
| TSDRM-1842P5 | 1842.5 | fo ± 37.5 | 3.3 | 1.5 | 1.5 | 45 at fo ± 1747.5 | 43.5 x 9.5 x 13.0 |

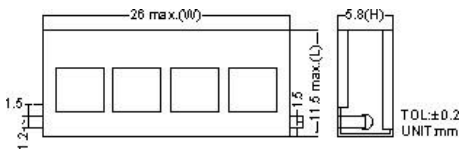

TYPE
AR



| Temstron No. | Center Frequency (MHz) | Band Width (MHz) min | Insertion Loss (dB) max. | Ripple in BW (dB) max. | V.S.W.R. Max. | Attenuation (dB) min. (MHz) | Dimension W x H x L (max) (mm) |
|--------------|------------------------|----------------------|--------------------------|------------------------|---------------|----------------------------------|--------------------------------|
| TSDRA-2400 | 2400.0 | fo ± 200 | 2.0 | 1.0 | 1.6 | 40 at fo - 540 | 23.0 x 4.0 x 11.0 |
| TSDRA-1240 | 1240.0 | fo ± 42.5 | 2.5 | 0.8 | 1.5 | 35 at fo ± 100 | 26.0 x 4.0 x 14.0 |
| TSDRA-1350 | 1350.0 | fo ± 68 | 3.0 | 0.5 | 1.5 | 45 at fo ± 140 | 29.0 x 4.0 x 13.0 |
| TSDRA-2500 | 2500.0 | fo ± 100 | 2.0 | 1.0 | 1.5 | 10 at fo ± 300 | 9.0 x 4.8 x 9.0 |
| TSDRA-915 | 915.0 | fo ± 13 | 2.8 | 1.0 | 1.5 | 12 at fo ± 32.5 | 9.5 x 4.8 x 10.0 |
| TSDRA-1260 | 1260.0 | fo ± 11 | 1.3 | 0.5 | 1.5 | 15 at fo ± 150 | 15.0 x 5.8 x 10.5 |
| TSDRA-1808 | 1808.0 | fo ± 50 | 1.5 | 0.5 | 1.5 | 50 at fo - 200 35at fo + 200 | 25.0 x 5.8 x 11.5 |
| TSDRA-1880 | 1880.0 | fo ± 5 | 1.5 | 0.5 | 1.5 | 45 at fo ± 140 | 30.0 x 5.8 x 11.0 |
| TSDRA-720 | 720.0 | fo ± 4 | 3.0 | 0.5 | 1.5 | 50 at fo ± 50 | 35.0 x 5.8 x 16.0 |
| TSDRA-1200 | 1200.0 | fo ± 100 | 3.0 | 1.0 | 1.5 | 40 at fo ± 200 | 40.0 x 5.8 x 15.0 |
| TSDRA-1100 | 1100.0 | fo ± 65 | 2.0 | 1.0 | 1.5 | 25 at fo ± 100 | 45.0 x 5.8 x 12.5 |
| TSDRA-4000 | 4000.0 | fo ± 250 | 2.5 | 1.0 | 2.0 | 5 at fo +395 15 at fo - 395 | 23.0 x 6.8 x 10.5 |
| TSDRA-1600 | 1600.0 | fo ± 30 | 1.2 | 0.5 | 1.6 | 15 at fo ± 100 | 29.0 x 6.8 x 12.5 |
| TSDRA-1484 | 1484.0 | fo ± 100 | 1.0 | 0.4 | 2.0 | 35 at fo - 200 20 at fo + 200 | 41.0 x 6.8 x 15.5 |
| TSDRA-1095 | 1095.0 | fo ± 150 | 2.0 | 1.0 | 2.0 | 20 at fo -200 | 47.0 x 6.8 x 12.5 |
| TSDRA-1050 | 1050.0 | fo ± 70 | 3.5 | 1.0 | 1.8 | 55 at fo ± 150 | 52.0 x 6.8 x 12.0 |
| TSDRA-410 | 410.0 | fo ± 1.5 | 3.5 | 0.5 | 1.5 | 40 at fo ± 20 | 27.0 x 7.5 x 25.0 |
| TSDRA-285 | 285.0 | fo ± 12 | 3.0 | 0.5 | 1.5 | 40 at fo ± 40 | 39.0 x 8.3 x32.0 |
| TSDRA-500 | 500.0 | fo ± 40 | 3.0 | 1.0 | 1.8 | 15 at fo ± 80 | 45.5 x 8.3 x 22.0 |
| TSDRA-720 | 720.0 | fo ± 50 | 3.0 | 1.0 | 2.0 | 55 at fo ± 130 | 52.0 x 8.3 x 16.0 |
| TSDRA-390 | 390.0 | fo ± 15 | 3.0 | 1.0 | 1.5 | 40 at fo ± 35 | 59.0 x 8.3 x 29.0 |
| TSDRA-1200 | 1200.0 | fo ± 12.5 | 5.0 | 1.0 | 2.0 | 35 at fo ± 27.5 | 39.0 x 8.3 x 12.5 |
| TSDRA-1150 | 1150.0 | fo ± 15 | 3.0 | 0.5 | 1.5 | 45 at fo ± 50 | 51.0 x 8.3 x 10.0 |
| TSDRA-980 | 980.0 | fo ± 20 | 2.5 | 0.6 | 1.5 | 70 at fo -230 | 20.0 x 5.8 x 12.0 |
| TSDRA-1400 | 1400.0 | fo ± 50 | 2.5 | 1.0 | 1.5 | 20 at fo ± 70 | 23.0 x 5.8 x 13.0 |
| TSDRA-2400 | 2400.0 | fo ± 165 | 4.5 | 1.0 | 1.8 | 35 at fo ± 300 | 26.0 x 5.8 x 11.5 |
| TSDRA-2600 | 2600.0 | fo ± 57.5 | 3.5 | 0.6 | 1.8 | 50 at fo ± 160 | 29.0 x 5.8 x 11.0 |

| Temstron No. | Center Frequency (MHz) | Band Width (MHz) min | Insertion Loss (dB) max. | Ripple in BW (dB) max. | V.S.W.R. Max. | Attenuation (dB) min. (MHz) | Dimension W x H x L (max) (mm) |
|---------------|------------------------|----------------------|--------------------------|------------------------|---------------|-----------------------------|--------------------------------|
| TSDRA-902P5 | 902.5 | fo ± 12.5 | 2.5 | 1.0 | 1.7 | 12 at fo ± 32.5 | 11.0 x 4.5 x 15.0 |
| TSDRA-947P5 | 947.5 | fo ± 12.5 | 2.5 | 1.0 | 1.7 | 12 at fo ± 32.5 | 11.0 x 4.5 x 15.0 |
| TSDRA-1950 | 1950.0 | fo ± 30 | 2.0 | 0.5 | 1.5 | 40 at fo ± 200 | 13.0 x 4.5 x 12.0 |
| TSDRA-2140 | 2140.0 | fo ± 30 | 2.0 | 0.5 | 1.5 | 40 at fo ± 200 | 13.0 x 4.5 x 12.0 |
| TSDRA-4520 | 4520.0 | fo ± 120 | 2.0 | 1.0 | 1.5 | 20 at fo - 500 | 13.6 x 4.2 x13.0 |
| TSDRA-2040 | 2040.0 | fo ± 150 | 3.0 | 1.0 | 1.5 | 55 at fo ± 360 | 26.0 x 4.5 x 12.0 |
| TSDRA-1500 | 1500.0 | fo ± 5 | 3.0 | 1.0 | 1.5 | 30 at fo ± 100 | 10.0 x 5.2 x 15.0 |
| TSDRA-2974 | 2974.0 | fo ± 30 | 3.0 | 1.0 | 1.5 | 45 at fo ± 200 | 18.5 x 5.0 x 14.0 |
| TSDRA-340 | 340.0 | fo ± 10 | 3.0 | 1.0 | 1.5 | 40 at fo ± 36 | 22.5 x 5.5 x 28.5 |
| TSDRA-2350 | 2350.0 | fo ± 55 | 3.0 | 1.0 | 1.6 | 40 at fo ± 150 | 26.5 x 6.0 x 11.5 |
| TSDRA-1090 | 1090.0 | fo ± 6.5 | 8.0 | 1.0 | 2.0 | 20 at fo ± 12 | 35.0 x 5.2 x 14.0 |
| TSDRA-1600 | 1600.0 | fo ± 50 | 2.0 | 0.5 | 1.5 | 40 at fo ± 200 | 26.5 x 6.5 x 14.5 |
| TSDRA-2300 | 2300.0 | fo ± 5 | 4.0 | 1.0 | 1.5 | 65 at fo ± 100 | 32.5 x 6.5 x 13.0 |
| TSDRA-2450 | 2450.0 | fo ± 5 | 0.8 | 0.5 | 1.5 | 60 at fo - 800 | 14.0 x 6.8 x 13.6 |
| TSDRA-957 | 957.0 | fo ± 3 | 4.0 | 1.0 | 1.5 | 45 at fo - 60 | 20.0 x 7.1 x 14.0 |
| TSDRA-390 | 390.0 | fo ± 8 | 3.0 | 1.0 | 1.5 | 15 at fo ± 20 | 27.0 x 7.5 x 26.5 |
| TSDRA-1590 | 1590.0 | fo ± 30 | 1.2 | 0.5 | 1.6 | 15 at fo ± 100 | 27.0 x 7.5 x 17.0 |
| TSDRA-1600 | 1600.0 | fo ± 4 | 5.0 | 0.5 | 2.0 | 65 at fo ± 70 | 38.5 x 7.5 x 15.0 |
| TSDRA-410 | 410.0 | fo ± 10 | 3.0 | 1.5 | 1.5 | 50 at fo ± 20 | 20.0 x 7.5 x 31.0 |
| TSDRA-1260 | 1260.0 | fo ± 7.5 | 6.0 | 0.8 | 1.5 | 60 at fo ± 30 | 38.0 x 7.5 x 14.5 |
| TSDRA-2330 | 2330.0 | fo ± 365 | 3.0 | 1.5 | 1.6 | 60 at fo - 660 | 50.0 x 7.5 x 16.0 |
| TSDRA-880 | 880.0 | fo ± 17 | 5.0 | 1.0 | 1.5 | 60 at fo ± 48 | 56.0 x 7.5 x 20.0 |
| TSDRA-955 | 955.0 | fo ± 12 | 3.0 | 1.0 | 1.5 | 35 at fo - 24 | 65.0 x 9.5 x 25.0 |
| TSDRA-1575P42 | 1575.42 | fo ± 5 | 0.8 | 0.5 | 1.5 | 30 at fo ± 50 | 40.0 x 11.5 x 20.0 |
| TSDRA-875 | 875.0 | fo ± 5 | 2.0 | 0.8 | 1.5 | 25 at fo + 20 | 42.5 x 11.5 x 19.5 |

TYPE
PIN & TEF & N



| Temstron No. | Center Frequency (MHz) | Band Width (MHz)min | Insertion Loss (dB)max. | Ripple in BW (dB)max. | V.S.W.R. Max. | Attenuation (dB)min.(MHz) | Operation Temperature (°C) |
|--------------|------------------------|---------------------|-------------------------|-----------------------|---------------|---------------------------|----------------------------|
| TPIN-900 | 900.0 | ± 10.0 | 2.5 | 1.0 | 1.5 | 50 at fo ± 100 | -60 ~ +100 |
| TPIN-1200 | 1200.0 | ± 15.0 | 2.0 | 1.0 | 1.5 | 50 at fo ± 110 | |
| TPIN-950 | 950.0 | ± 10.0 | 2.0 | 1.0 | 1.5 | 50 at fo ± 50 | |
| TPIN-1051 | 1051.0 | ± 10.0 | 2.5 | 1.0 | 1.5 | 40 at fo ± 50 | |
| TPIN-1004 | 1004.0 | ± 10.0 | 2.5 | 1.0 | 1.5 | 50 at fo ± 50 | |
| TPIN-945 | 945.0 | ± 10.0 | 3.0 | 1.0 | 1.5 | 60 at fo ± 50 | |

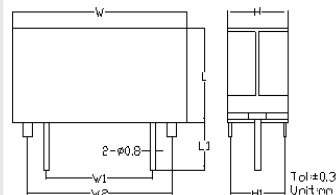

| Temstron No. | Center Frequency (MHz) | Band Width (MHz)min | Insertion Loss (dB)max. | Ripple in BW (dB)max. | V.S.W.R. Max. | Attenuation (dB)min.(MHz) | Operation Temperature (°C) |
|----------------|------------------------|---------------------|-------------------------|-----------------------|---------------|----------------------------------|----------------------------|
| TTEF-5P5 | 5.5 | 25 | 2.0 | 0.5 | 1.5 | 70 at fo ± 50 | -60 ~ +100 |
| TTEF-5P8 | 5.8 | 43 | 2.0 | 1.0 | 2.0 | 60 at fo + 75 55 at fo -75 | |
| TTEF-5P5-5P6 | 5.5~5.6 | 16 | 5.0 | 1.0 | 1.5 | 20 at fo ± 20 | |
| TTEF-6P5-12P5 | 6.5~12.5 | 50 | 2.0 | 0.5 | 2.0 | 80 at fo - 250 60 at fo + 250 | |
| TTEF-13P5-15P5 | 13.5~15.5 | 50 | 2.0 | 0.5 | 2.0 | 70 at fo - 250 50 at fo + 250 | |
| TTEF-16P5 | 16.5 | 50 | 2.0 | 0.5 | 2.0 | 70 at fo - 250 45 at fo + 250 | |
| TTEF-17P5 | 17.5 | 50 | 2.0 | 0.5 | 2.0 | 70 at fo - 250 35 at fo + 250 | |
| TTEF-5P6 | 5.6 | 56 | 1.5 | 1.0 | 1.5 | 65 at fo ± 100 | |

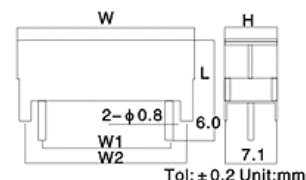
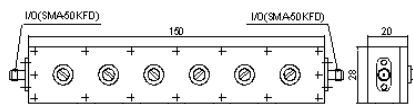

| Temstron No. | Center Frequency (MHz) | Band Width (MHz) min | Insertion Loss (dB) max. | Ripple in BW (dB) max. | V.S.W.R. Max. | Attenuation (dB) min. (MHz) | Dimension W x H x L (max) (mm) |
|--------------|------------------------|----------------------|--------------------------|------------------------|---------------|---------------------------------|--------------------------------|
| TSDRN-1200 | 1200.0 | fo ± 22.5 | 3.0 | 0.5 | 1.5 | 50 at fo ± 110 | 21.5 x 7.5 x 11.0 |
| TSDRN-1100 | 1100.0 | fo ± 22.5 | 3.0 | 0.5 | 1.5 | 75 at fo - 115 60 at fo +115 | 26.5 x 7.5 x 11.0 |
| TSDRN-3850 | 3850.0 | fo ± 5.0 | 4.0 | 1.0 | 1.5 | 50 at fo ± 80 | 25.5 x 7.5 x 10.0 |
| TSDRN-1360 | 1360.0 | fo ± 4.0 | 4.0 | 0.5 | 1.5 | 50 at fo ± 70 | 32.5 x 7.5 x 10.0 |
| TSDRN-900 | 900.0 | fo ± 3.0 | 8.5 | 3.0 | 1.5 | 50 at fo ± 10 | 38.0 x 7.5 x 12.0 |
| TSDRN-4450 | 4450.0 | fo ± 1.0 | 6.0 | 1.0 | 1.5 | 80 at fo ± 50 | 38.0 x 7.5 x 12.0 |
| TSDRN-1250 | 1250.0 | fo ± 5.0 | 4.5 | 0.5 | 1.5 | 65 at fo ± 30 | 49.5 x 7.5 x 12.0 |
| TSDRN-1280 | 1280.0 | fo ± 30.0 | 2.0 | 1.0 | 1.5 | 15 at fo ± 150 | 10.0 x 5.0 x 10.0 |
| TSDRN-2600 | 2600.0 | fo ± 33.0 | 4.0 | 1.0 | 1.8 | 40 at fo ± 80 | 24.0 x 5.5 x 15.0 |
| TSDRN-1230 | 1230.0 | fo ± 10.0 | 6.0 | 1.0 | 2.0 | 40 at fo ± 25 | 42.0 x 6.0 x 15.0 |
| TSDRN-1800 | 1800.0 | fo ± 20.0 | 5.0 | 1.0 | 1.5 | 55 at fo ± 50 | 46.5 x 6.0 x 15.0 |
| TSDRN-1000 | 1000.0 | fo ± 11.0 | 3.0 | 0.5 | 1.5 | 40 at fo ± 60 | 24.0 x 6.5 x 15.0 |
| TSDRN-1300 | 1300.0 | fo ± 25.0 | 3.0 | 0.5 | 1.5 | 60 at fo ± 115 | 28.0 x 6.5 x 15.0 |
| TSDRN-1220 | 1220.0 | fo ± 18.5 | 3.0 | 0.5 | 1.5 | 55 at fo ± 70 | 33.0 x 6.5 x 15.0 |
| TSDRN-1350 | 1350.0 | fo ± 81.5 | 2.5 | 0.5 | 1.5 | 55 at fo ± 200 | 45.0 x 6.5 x 15.0 |
| TSDRN-1137 | 1137.0 | fo ± 10.0 | 3.0 | 0.5 | 1.5 | 40 at fo ± 50 | 28.0 x 7.5 x 15.0 |
| TSDRN-3350 | 3350.0 | fo ± 25.0 | 4.0 | 1.0 | 1.5 | 35 at fo ± 75 | 35.0 x 7.5 x 10.0 |
| TSDRN-1500 | 1500.0 | fo ± 20.0 | 3.5 | 1.0 | 1.5 | 50 at fo ± 60 | 40.0 x 7.5 x 15.0 |
| TSDRN-4520 | 4520.0 | fo ± 30.0 | 5.0 | 1.0 | 1.5 | 45 at fo ± 85 | 52.0 x 7.5 x 15.0 |

SMD DR DUPLEXER

TYPE
AR



For Base station, Repeater

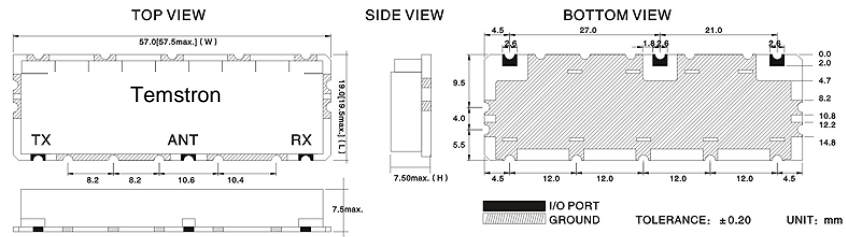

| Temstron No. | Center Frequency (MHz) | Band Width (MHz) min | Insertion Loss (dB) max. | V.S.W.R. Max. | Attenuation (dB) min. (MHz) | Dimension W x H x L (max) (mm) | Application | |
|-----------------|------------------------|----------------------|--------------------------|---------------|-----------------------------|--------------------------------|---------------|------------|
| TSDDA-3430/3530 | TX | 3430.0 | fo ± 30 | 6.5 | 2.0 | 18(fr ± 30) | 36 x 44 x 5.5 | MMDS |
| | RX | 3530.5 | fo ± 30 | 6.5 | 2.0 | 18(ft ± 30) | | |
| TSDDA-830/875 | TX | 830.0 | fo ± 5 | 2.5 | 1.5 | 55(fr ± 5) | 47 x 19 x 7.0 | CHINA CDMA |
| | RX | 875.0 | fo ± 5 | 2.5 | 1.5 | 55(ft ± 5) | | |
| TSDDA-830/875 | TX | 830.0 | fo ± 5 | 2.8 | 1.5 | 50(fr ± 5) | 57 x 19 x 7.5 | CHINA CDMA |
| | RX | 875.0 | fo ± 5 | 2.5 | 1.5 | 60(ft ± 5) | | |
| TSDDA-830/875 | TX | 830.0 | fo ± 5 | 2.0 | 1.5 | 48(fr ± 5) | 100 x 34 x 14 | CHINA CDMA |
| | RX | 875.0 | fo ± 5 | 2.0 | 1.5 | 50(ft ± 5) | | |
| TSDDA-1950/2140 | TX | 1950.0 | fo ± 30 | 3.0 | 1.8 | 45(fr ± 30) | 47 x 18 x 7.0 | IMT-2000 |
| | RX | 2140.0 | fo ± 30 | 3.0 | 1.8 | 45(ft ± 30) | | |
| TSDDA-902/947 | TX | 902.5 | fo ± 12.5 | 2.4 | 1.7 | 32(fr ± 12.5) | 21 x 15 x 4.5 | GSM |
| | RX | 947.5 | fo ± 12.5 | 3.2 | 1.8 | 30(ft ± 12.5) | | |
| TSDDA-902/947 | TX | 902.5 | fo ± 12.5 | 4.3 | 1.8 | 42(fr ± 12.5) | 47 x 19 x 7.0 | GSM |
| | RX | 947.5 | fo ± 12.5 | 3.8 | 1.8 | 45(ft ± 12.5) | | |
| TSDDA-897/942 | TX | 897.0 | fo ± 12 | 3.1 | 1.5 | 44(fr ± 12.5) | 57 x 19 x 7.5 | GSM |
| | RX | 942.5 | fo ± 12 | 3.1 | 1.5 | 45(ft ± 12.5) | | |
| TSDDA-1747/1842 | TX | 1747.5 | fo ± 37.5 | 3.8 | 1.5 | 25(fr ± 37.5) | 47 x 18 x 7.0 | DCS |
| | RX | 1842.5 | fo ± 37.5 | 3.8 | 1.5 | 18ft ± 37.5) | | |
| TSDDA-1595/2492 | TX | 1595.0 | fo ± 25 | 2.5 | 1.8 | 30 | 20 x 14 x 4.0 | GSM |
| | RX | 2492.0 | fo ± 20 | 3.0 | 1.8 | (2200~2300) | | |

| Temstron No. | Center Frequency (MHz) | Band Width (MHz) min | Insertion Loss (dB) max. | V.S.W.R. Max. | Attenuation (dB) min. (MHz) | Dimension W x H x L (max) (mm) | Application | |
|---------------------|------------------------|----------------------|--------------------------|---------------|-----------------------------|--------------------------------|-------------------|--------------|
| TSDDA-830/875 | TX | 830.0 | fo ± 5 | 2.5 | 1.7 | 45 at fr ± 5.0 | 24 x 10 x 4.1 | CHINA CDMA |
| | RX | 875.0 | fo ± 5 | 3.2 | 1.7 | 50 at ft ± 5.0 | | |
| TSDDA-830/875 | TX | 830.0 | fo ± 5 | 2.4 | 1.5 | 45 at fr ± 5.0 | 30 x 12 x 7.5 | CHINA CDMA |
| | RX | 875.0 | fo ± 5 | 3.3 | 1.5 | 60 at ft ± 5.0 | | |
| TSDDA-836.5/881.5 | TX | 836.5 | fo ± 12.5 | 1.8 | 1.5 | 60 at fr ± 12.5 | 42 x 17.5 x 9.5 | GSM |
| | RX | 881.5 | fo ± 12.5 | 1.8 | 1.5 | 60 at ft ± 12.5 | | |
| TSDDA-902.5/947.5 | TX | 902.5 | fo ± 12.5 | 2.5 | 1.5 | 55 at fr ± 12.5 | 42 x 17.5 x 9.5 | GSM |
| | RX | 947.5 | fo ± 12.5 | 2.5 | 1.5 | 55 at ft ± 12.5 | | |
| TSDDA-897/942 | TX | 897.0 | fo ± 12.0 | 2.3 | 1.5 | 55 at fr ± 12.0 | 42 x 17.5 x 9.5 | GSM |
| | RX | 942.0 | fo ± 12.0 | 2.0 | 1.5 | 55 at ft ± 12.0 | | |
| TSDDA-912/957 | TX | 912.0 | fo ± 3.0 | 2.0 | 1.5 | 55 at fr ± 3.0 | 42 x 17.5 x 9.5 | GSM |
| | RX | 957.0 | fo ± 3.0 | 2.0 | 1.5 | 55 at ft ± 3.0 | | |
| TSDDA-1747/1842 | TX | 1747.0 | fo ± 37.5 | 2.8 | 1.5 | 25 at fr ± 37.5 | 43.5 x 13.0 x 9.5 | DCS |
| | RX | 1842.0 | fo ± 37.5 | 2.8 | 1.5 | 30 at ft ± 37.5 | | |
| TSDDA-1950/2140 | TX | 1950.0 | fo ± 30.0 | 2.0 | 1.5 | 55 at fr ± 30.0 | 26 x 5.6 x 4.1 | IMT-2000 |
| | RX | 2140.0 | fo ± 30.0 | 2.0 | 1.5 | 55 at ft ± 30.0 | | |
| TSDDA-1880/1960 | TX | 1880.0 | fo ± 30.0 | 3.0 | 1.5 | 40 at fr ± 30.0 | 43.5 x 13.0 x 9.5 | US-PCS |
| | RX | 1960.0 | fo ± 30.0 | 3.0 | 1.5 | 40 at ft ± 30.0 | | |
| TSDDA-1950/2140 | TX | 1950.0 | fo ± 30.0 | 3.0 | 1.5 | 45 at fr ± 30.0 | 43.5 x 13.0 x 9.5 | IMT-2000 |
| | RX | 2140.0 | fo ± 30.0 | 3.0 | 1.5 | 45 at ft ± 30.0 | | |
| TSDDA-3483.5/3583.5 | TX | 3483.5 | fo ± 16.5 | 2.5 | 1.5 | 40 at fr ± 16.5 | 30 x 8.8 x 5.0 | Wireless-LAN |
| | RX | 3583.5 | fo ± 16.5 | 2.5 | 1.5 | 40 at ft ± 16.5 | | |

DR RESONATOR

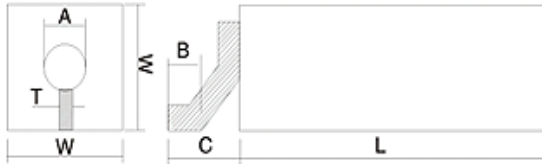
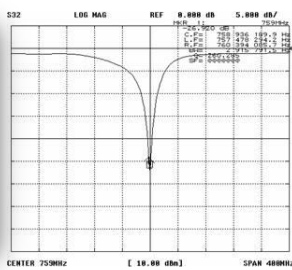

| Type | Part | W (O/D) | A (I/D) (mm) | B (mm) | C (mm) | T (mm) |
|------|------|------------|---------------|-------------|--------|--------|
| R120 | | 12.0 ± 0.2 | 1 Φ4.0 ± 0.2 | without tab | / | / |
| | | | 2 Φ3.55 ± 0.2 | 1.5 | 3.2 | 1.0 |
| R100 | | 10.0 ± 0.2 | 1 Φ3.3 ± 0.2 | 1.3 | 3.0 | 1.0 |
| R80 | | 8.0 ± 0.2 | 1 Φ2.7 ± 0.2 | 1.3 | 2.6 | 0.7 |
| R60 | | 6.0 ± 0.2 | 1 Φ2.5 ± 0.2 | without tab | / | / |
| | | | 2 Φ2.2 ± 0.2 | | | |
| | | | 3 Φ2.2 ± 0.2 | 1.2 | 2.4 | 0.7 |
| R50 | | 5.0 ± 0.2 | 1 Φ1.8 ± 0.2 | 1.0 | 2.2 | 0.6 |
| | | | 2 Φ1.5 ± 0.2 | | | |
| R40 | | 4.0 ± 0.1 | 1 Φ1.8 ± 0.1 | Without tab | / | / |
| | | | 2 Φ1.5 ± 0.1 | | | |
| | | | 3 Φ1.2 ± 0.1 | | | |
| R30 | | 3.0 ± 0.1 | 1 Φ1.0 ± 0.1 | 0.7 | 1.5 | 0.5 |
| R20 | | 2.1 ± 0.1 | 1 Φ0.6 ± 0.1 | 0.5 | 1.2 | 0.5 |

| Material | Dielectric Constant | Tf ¹⁾ | Type | Characteristic Impedance (Ω) | Wave Length | Frequency Range (MHz) | Q ²⁾ (min) |
|----------|---------------------|------------------|-----------|------------------------------|-------------|-----------------------|-----------------------|
| A Series | 20 ± 1 | 0 ± 10 | R120 | ①15 ② 17 | λ/4 | 800~1300 | 800 |
| | | | R100 | 16 | λ/2 | 1600~2700 | 1000 |
| | | | | | λ/4 | 800~1300 | 700 |
| | | | R080 | 15 | λ/2 | 1600~3200 | 800 |
| | | | | | λ/4 | 1000~3200 | 650 |
| | | | R060 | ①12 ② 14 ③15 | λ/4 | 2000~3000 | 700 |
| | | | | | λ/2 | 1000~2700 | 550 |
| | | | R050 | ①14 ② 17 | λ/4 | 2000~3000 | 600 |
| | | | | | λ/2 | 1300~3000 | 450 |
| R040 | ①11 ②14 ③ 17 | λ/4 | 2500~4000 | 500 | | | |
| | | λ/2 | 1300~4000 | 380 | | | |
| B Series | 36 ± 1 | 0 ± 10 | R120 | ①12 ② 13 | λ/4 | 600~1000 | 700 |
| | | | R100 | 12 | λ/2 | 1200~2400 | 900 |
| | | | | | λ/4 | 600~1200 | 600 |
| | | | R080 | 12 | λ/2 | 1200~2400 | 800 |
| | | | | | λ/4 | 800~1500 | 500 |
| | | | R060 | ①10 ② 11 ③12 | λ/4 | 1600~3000 | 700 |
| | | | | | λ/2 | 800~1800 | 450 |
| | | | R050 | ①11 ② 13 | λ/4 | 1600~3500 | 550 |
| | | | | | λ/2 | 800~1800 | 380 |
| R040 | ①9 ② 11 ③ 13 | λ/4 | 1600~3500 | 450 | | | |
| | | λ/2 | 1000~2700 | 320 | | | |
| R030 | 12 | λ/4 | 2000~4800 | 400 | | | |
| | | λ/2 | 1300~3000 | 220 | | | |
| R020 | 13 | λ/4 | 1300~3000 | 220 | | | |
| | | λ/4 | 400~800 | 650 | | | |
| C Series | 80 ± 1 | 0 ± 10 | R120 | ①7 ② 8 | λ/4 | 800~1500 | 700 |
| | | | R100 | 7 | λ/2 | 600~800 | 550 |
| | | | | | λ/4 | 1200~2400 | 650 |
| | | | R080 | 7 | λ/4 | 440~1000 | 450 |
| | | | | | λ/2 | 1000~1500 | 550 |
| | | | R060 | ①6 ② 7 ③ 7 | λ/4 | 440~1300 | 400 |
| | | | | | λ/2 | 1000~2200 | 470 |
| | | | R050 | ①7 ② 8 | λ/4 | 500~1800 | 380 |
| | | | | | λ/2 | 1000~3000 | 450 |
| R040 | ①6 ② 7 ③ 8 | λ/4 | 900~1600 | 200 | | | |
| | | λ/2 | 2000~4800 | 300 | | | |
| R030 | 7 | λ/4 | 900~1600 | 250 | | | |
| R020 | 8 | λ/4 | 900~1600 | 150 | | | |